

**Canon**

**Tripod Grip**

**HG-200TBR**

Advanced User Guide

**EN**

## Contents

---

Introduction. . . . .	3
Instruction Manuals. . . . .	4
About This Guide. . . . .	5
Safety Instructions. . . . .	6
Part Names. . . . .	8
Preparing the Remote Control. . . . .	10
Adjusting the Angle of the Camera Mount. . . . .	12
Attaching a Camera. . . . .	16
Attaching an External Microphone. . . . .	19
Holding the Tripod Grip to Shoot. . . . .	25
Tripodding a Camera to Shoot. . . . .	26
Specifications. . . . .	28
Regulations. . . . .	29

## Introduction

---

The Tripod Grip HG-200TBR is a handgrip that allows you to shoot while operating the camera with the attached Wireless Remote Control BR-E2.

Legs can also be extended from the grip portion for use as a tripod. The included microphone brackets allow you to attach an external microphone such as a stereo microphone (sold separately) to a camera without a hot shoe.

The microphone brackets can also be used with cameras capable of vertical movie shooting.

### Before use, be sure to read the following

To avoid accidents, first read the "[Safety Instructions](#)". Also read this Advanced User Guide carefully to ensure correct use.

Also, read the instructions for the Wireless Remote Control BR-E2.



#### Caution

- This product can withstand up to 1 kg/35.3 oz. of weight. Ensure that the weight of the mounted camera, lens, etc. does not exceed 1 kg/35.3 oz. Using the product with this weight exceeded may result in product breakage.

- [Instruction Manuals](#)
- [About This Guide](#)
- [Safety Instructions](#)
- [Part Names](#)



The included Instruction Manual provides basic product information.

- **Advanced User Guide**

Complete instructions are provided in this Advanced User Guide.  
For the latest Advanced User Guide, refer to the following website.

<https://cam.start.canon/A010/>



## About This Guide



---

 [Icons in This Manual](#)

 [Basic Assumptions](#)

### Icons in This Manual

---

	Links to pages with related topics.
	Warnings to prevent potential problems during operation.
	Supplemental information.

### Basic Assumptions

---

- The rotation of the camera mount is explained under the premise that the Canon logo faces the same direction as the left/right lock release button.
- In this manual, wireless remote controllers are referred to as “remote controls.”

## Safety Instructions

---

Be sure to read these instructions in order to operate the product safely.  
Follow these instructions to prevent injury or harm to the operator of the product or others.



### WARNING

Denotes the risk of serious injury or death.

- Keep the product out of the reach of young children.
- Keep batteries out of the reach of children.
- The battery is dangerous if swallowed. If swallowed, seek immediate medical assistance.
- **PRODUCT CONTAINS BUTTON/COIN CELL BATTERY**  
Button/coin cell batteries are hazardous and must be kept out of reach of children at all times, whether new or used.  
These batteries can cause severe or fatal injuries in 2 hours or less if swallowed or placed inside any part of the body.  
If it is suspected a button/coin cell battery has been swallowed or placed inside any part of the body, seek medical attention immediately.
- Use only power sources specified in this instruction manual for use with the product.
- Do not disassemble or modify the product.
- Do not expose the product to strong shocks or vibration.
- Do not touch any exposed internal parts.
- Stop using the product in any case of unusual circumstances such as the presence of smoke or a strange smell.
- Do not use organic solvents such as alcohol, benzene or paint thinner to clean the product.
- Do not get the product wet. Do not insert foreign objects or liquids into the product.
- Do not use the product where flammable gases may be present.  
This may cause electric shock, explosion or fire.
- Observe the following instructions when using commercially available batteries or provided battery packs.
  - Do not heat batteries/battery packs or expose them to fire.
  - Do not expose the terminals to dirt or let them come into contact with metallic pins or other metal objects.
  - Do not use leaking batteries/battery packs.
  - When disposing of batteries/battery packs, insulate the terminals with tape or other means.  
This may cause electric shock, explosion or fire.
  - If a battery/battery pack leaks and the material contacts your skin or clothing, flush the exposed area thoroughly with running water. In case of eye contact, flush thoroughly with copious amounts of clean running water and seek immediate medical assistance.
- Do not leave the product in places exposed to extremely high or low temperatures.  
The product may become extremely hot/cold and cause burns or injury when touched.

## Caution

Follow the cautions below. Otherwise physical injury or property damage may result.

- Do not leave the product in places exposed to extremely high or low temperatures. The product may become extremely hot/cold and cause burns or injury when touched.
- Do not touch any parts inside the product. Do not allow your fingers to get caught when opening/closing the tripod legs. This may cause injury.

## Part Names

---

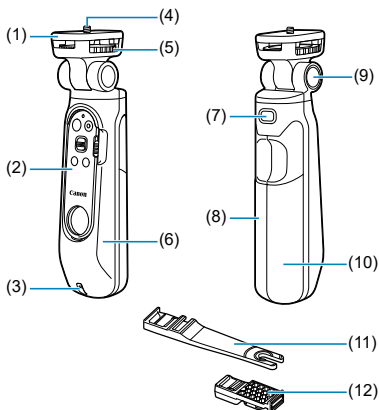

- 
- |      |                                |
|------|--------------------------------|
| (1)  | Camera mount                   |
| (2)  | Wireless Remote Control BR-E2  |
| (3)  | Strap mount                    |
| (4)  | Tripod screw                   |
| (5)  | Attach/detach dial             |
| (6)  | Body                           |
| (7)  | Left/right lock release button |
| (8)  | Leg R                          |
| (9)  | Front/back lock release button |
| (10) | Leg L                          |
| (11) | Microphone bracket L           |
| (12) | Microphone bracket S           |
-



## Note

- The product does not come with a strap.
- When not using the microphone brackets, microphone bracket L and microphone bracket S can be stowed as shown.

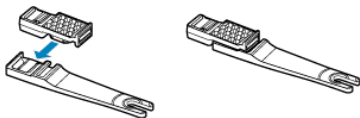

## Preparing the Remote Control

---

[Pairing the Camera and BR-E2](#)

[Attaching the BR-E2](#)

[Removing the BR-E2](#)

### Pairing the Camera and BR-E2

---

- See the instructions for your camera and the BR-E2.

### Attaching the BR-E2

---

- With the BR-E2 at an angle, press it upward into the body of the tripod grip (rubber portion) (1).
- With the BR-E2 pressed upward into the body, swing its bottom into the body of the tripod grip (2).



## Removing the BR-E2

- With a finger where shown in the BR-E2 (strap hole) (1), pull outward to remove (2).

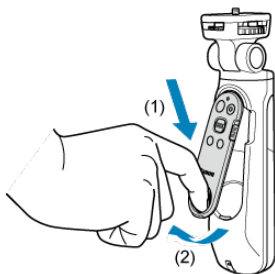

### ⚠ Caution

- Do not place your finger in the strap hole after removing the BR-E2.

## Adjusting the Angle of the Camera Mount

---

[Adjusting the Tilt of the Camera Mount](#)

[Camera Mount Turning](#)

### Adjusting the Tilt of the Camera Mount

---

1. Hold the front/back lock release button pressed.

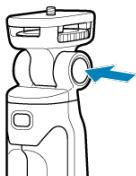

2. Tilt the camera mount.

- The camera mount can be locked every 15°.

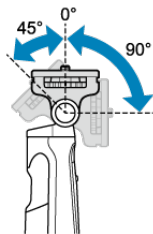

### **3. Release the front/back lock release button.**

- Check that the camera mount is locked.

## Camera Mount Turning

1. Hold the left/right lock release button pressed.

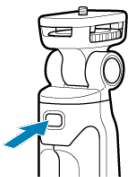

2. Turn the camera mount.

- The camera mount can be locked every 90°.

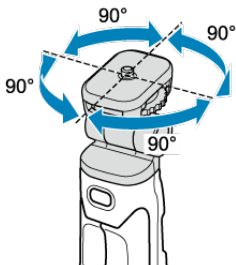

3. Release the left/right lock release button.

- Check that the camera mount is locked.

 **Caution**

- If the camera is attached on the camera mount, hold the camera before adjusting the tilt of the camera mount or turning it to avoid pinching your finger or dropping the camera.
- Before changing the front/back or left/right rotation angle, make sure your fingers are not obstructing movement to avoid pinching them.

## Attaching a Camera

---

[Horizontal Shooting](#)

[Vertical Shooting](#)

Insert the battery and memory card into the camera. Make sure the camera is turned off before attaching the camera.

---

### Horizontal Shooting

---

- Set the camera monitor and the BR-E2 button panel in the same orientation, and then insert the tripod screw in the tripod socket on the camera (1).
- Turn the attach/detach dial to lock the camera (2).
- Attach the camera securely so that it does not detach from the mount.

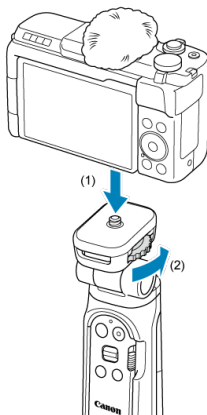

- To remove the camera, reverse the order.

## Vertical Shooting

### Note

- If your model has a tripod socket for vertical shooting, you can perform vertical shooting by attaching the camera vertically.

### 1. Attach the camera to the camera mount.

- Set the camera monitor and tripod leg R in the same orientation, and then insert the tripod screw into the tripod socket on the camera (1).
- Turn the attach/detach dial to lock the camera (2).
- Attach the camera securely so that it does not detach from the camera mount.

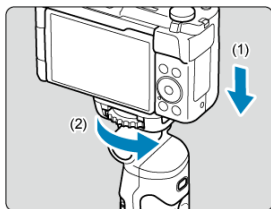

### 2. Turn the camera mount.

- While holding the left/right lock release button, turn the camera mount so that the camera monitor and the BR-E2 button panel are facing the same direction.

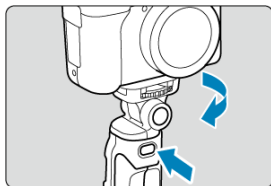

### 3. Tilt the camera mount.

- Tilt the camera mount 90° while holding the front/back lock release button.

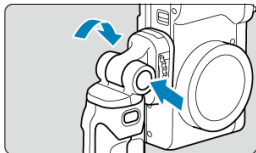

- To remove the camera, reverse the order.

# Attaching an External Microphone

---

[Horizontal Shooting](#)

[Vertical Shooting](#)

Use the microphone bracket when attaching an external microphone.

---

## Horizontal Shooting

---

1. Attach the camera as shown (📷).

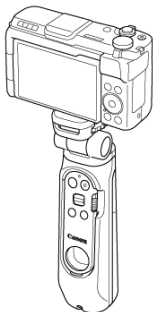

2. Insert microphone bracket L in the camera mount.

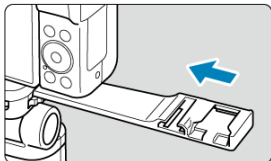

**3. Attach the external microphone to microphone bracket L.**

- Refer to the external microphone's instructions on how to attach.

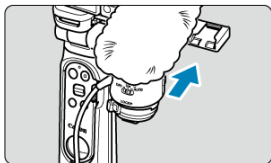

**4. Attach the connector from the external microphone to the external microphone IN terminal on the camera.**

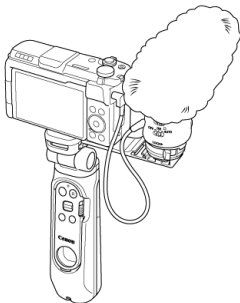
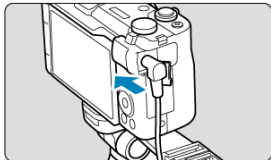

- To remove the camera, reverse the order.

 **Caution**

- Avoid mounting an item other than an external microphone on microphone bracket L.
- To remove the external microphone from microphone bracket L, first disconnect the external microphone connector.
- When removing microphone bracket L from the camera mount, check that you are not pulling the bracket in the direction of nearby persons or a wall.

1. Attach the camera as shown (🔗).



2. Insert microphone bracket S into microphone bracket L.

- Do not insert microphone bracket S backwards.

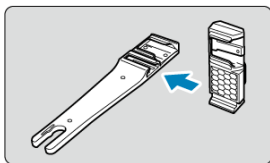

3. Insert microphone bracket L in the camera mount.

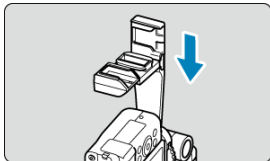

**4. Attach the external microphone to microphone bracket S.**

- Refer to the external microphone's instructions on how to attach.

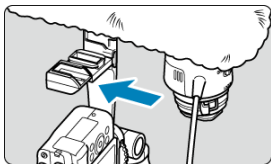

**5. Attach the connector from the external microphone to the external microphone IN terminal on the camera.**

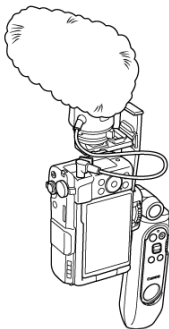
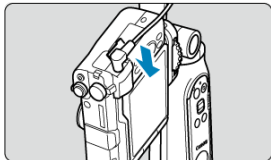

- To remove the camera, reverse the order.

 **Caution**

- Avoid mounting an item other than an external microphone on microphone bracket S.
- To remove the external microphone from microphone bracket S, first disconnect the external microphone connector.
- When removing microphone bracket L from the camera mount, check that you are not pulling the bracket in the direction of nearby persons or a wall.

## Holding the Tripod Grip to Shoot

---

Hold the tripod grip as shown. The camera can be operated by pressing the remote control button.

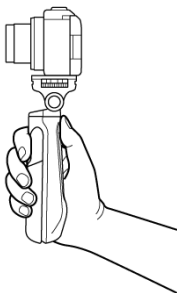

### Caution

- It is recommended that you attach and use the strap.
- If the front/back lock release button or left/right lock release button have not fully returned, the camera mount is not locked in place.  
Check that the front/back lock release button or left/right lock release button have fully returned.  
If the lock release button have not fully returned, move the camera mount until the button returns.
- Depending on the camera, changing the angle may unbalance the camera. Adjust to angles where the camera is stably balanced.

## Tripodding a Camera to Shoot

---

- Open tripod legs R/L as shown.

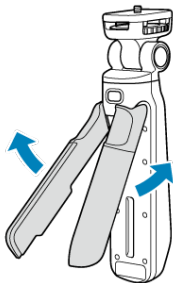

- Open tripod legs R/L as far as they will go, place on a level surface, and make sure it is stable.

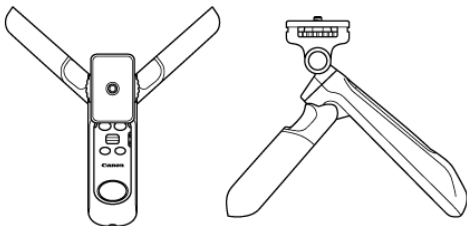

- Horizontal shooting example

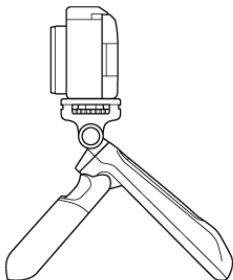

- Vertical shooting example

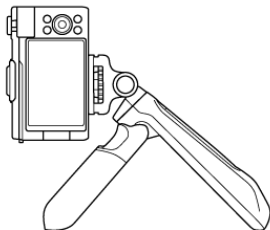

**!** Caution

- Be careful not to pinch your fingers.
- Do not place in areas where the tripod might fall over, such as locations with windy conditions or vibrations.

## Specifications

---

Size	Approx. 38.6 (W) x 190.0 (H) x 43.4 (D) mm / 1.53 (W) x 7.49 (H) x 1.71 (D) in. (grip form)
	Approx. 172.4 (W) x 148.5 (H) x 174.1 (D) mm / 6.79 (W) x 5.85 (H) x 6.86 (D) in. (tripod form)
Weight	Approx. 180 g / 6.35 oz. (body and BR-E2 (including battery))
	Approx. 164 g / 5.78 oz. (body only)

- Microphone bracket not included.
- All the data above is based on Canon's testing standards.
- Product specifications and the exterior are subject to change without notice.

## Regulations

---

Only for European Union and EEA (Norway, Iceland and Liechtenstein) and United Kingdom



These symbols indicate that this product is not to be disposed of with your household waste, according to the WEEE Directive (2012/19/EU), the Battery Regulation ((EU) 2023/1542) and/or national legislation implementing those Directives and Regulation and the UK Waste Electrical and Electronic Equipment Regulations and the UK Batteries and Accumulators Regulations.

If a chemical symbol is printed beneath the symbol shown above, in accordance with the Battery Regulation and the UK Batteries and Accumulators Regulations, this indicates that a heavy metal (Hg = Mercury, Cd = Cadmium, Pb = Lead) is present in this battery or accumulator at a concentration above an applicable threshold specified in the Battery Regulation and the UK Batteries and Accumulators Regulations. This product should be handed over to a designated collection point, e.g., on an authorized one-for-one basis when you buy a new similar product or to an authorized collection site for recycling waste electrical and electronic equipment (EEE) and batteries and accumulators. Improper handling of this type of waste could have a possible impact on the environment and human health due to potentially hazardous substances that are generally associated with EEE. Your cooperation in the correct disposal of this product will contribute to the effective usage of natural resources. For more information about the recycling of this product, please contact your local city office, waste authority, approved scheme or your household waste disposal service or visit

[www.canon-europe.com/sustainability/approach/](http://www.canon-europe.com/sustainability/approach/).